

## Speed Switch

1. Turn off power at the breaker. ⚡
2. Locate the speed switch (normally found with the capacitor inside the switch housing or light kit).
3. Unscrew the nut/grommet to release the defective switch.
4. With a pick, unfolded paperclip, or other pointed tool, push down the flap holding the wire inside the switch to release each of the 4 wires.
5. Install the replacement switch by sliding each wire to the matching numbered slot. Use the diagram to match the wire to the slot. Tug the wires to verify that they are secured in place.

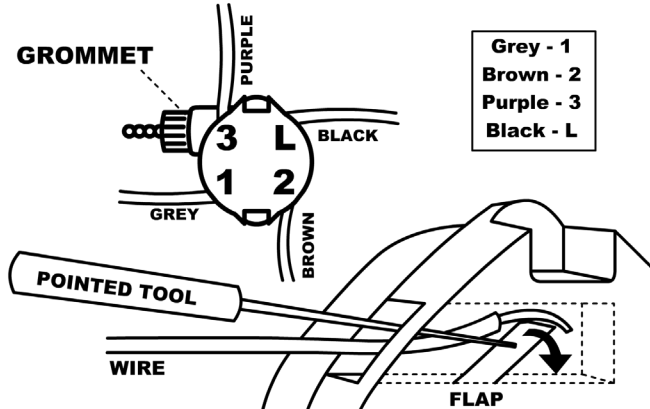

## Light Switch

1. Turn off power at the breaker. ⚡
2. Locate the light switch (normally found in the light kit or switch housing)
3. Unscrew the nut/grommet to release the defective switch.
4. Cut the wires on each side of the defective switch.
5. The defective switch can now be removed.
6. Strip the ends of the cut wires with a wire stripper.
7. Connect the wires from the replacement switch to the stripped wires using wire nuts and electrical tape.

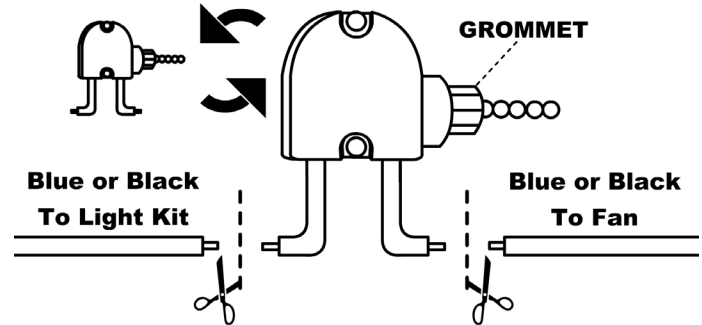

⚡ Warning: Risk of Electric Shock. Damaged parts may discharge, handle with care or contact an electrician. ⚡