

Wireless Remotes

1. Open the battery compartment of the remote and install a compatible battery.
 2. Match the dipswitch code on the remote with the dipswitch code on the fan's receiver. The code must match or the fan will not work.
- Note: Some remotes will have a 5th DIM/ON dipswitch. If your fan is using dimmable bulbs or has a dimmable LED, set the switch to the "DIM" position. If your fan is using non-dimmable bulbs or is not responding to the remote, set the switch to the "ON" position.

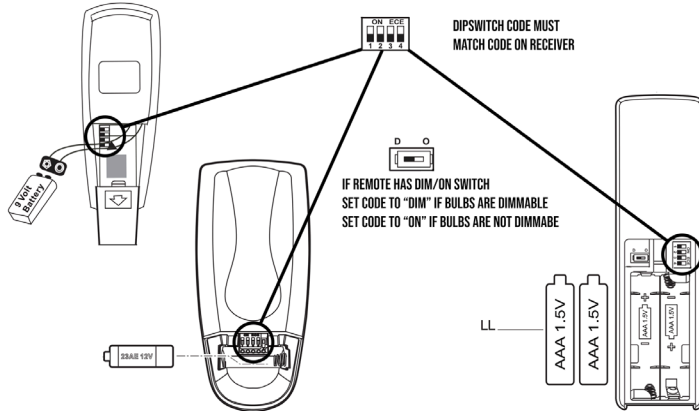

Wired Wall Remotes

1. Turn off power at the breaker. ⚡
 2. Unwire and remove the defective switch from the wall box.
 3. Wire the new wall switch using the owner's manual for reference.
 4. Mount the new wall switch and wall plate.
 5. Restore power from the breaker.
- Note: Some wall remotes will require a battery. Check the owner's manual to verify.
- Note: If the fan uses a receiver be sure to match the dipswitch code.

